

REVISION

1	
2	5533
3	
4	
5	
6	
7	
8	
9	
10	
11	
12	
13	
14	
15	
16	
17	
18	
19	
20	

NOTE: ITEMS MARKED "RV" ONLY AVAILABLE AS RELEASE VALVE ASSEMBLY. ITEM 58

NOTE: ITEMS MARKED "X" SUPPLIED IN KIT HP232TP1-K ONLY

IMPORTANT

WHEN ORDERING SPARES YOU MUST STATE THE FULL PART NUMBER AND THE PRODUCT SERIAL NUMBER - FROM THE LABEL TO PROTECT YOUR WARRANTY ALWAYS USE GENUINE HI-FORCE PARTS

MANUALLY OPERATED PUMP

SERIAL NUMBERS

FROM DT0642

PRODUCT NO.

HP232

SHT 1 OF
1 SHTS

ITEM NO.	PART NO.	DESCRIPTION	QTY.	SPARE PARTS	SERVICE PARTS
01	HP232-01	Pump Housing	1		
02		Oil Filter	1	x	✓
03		Ring	2	x	✓
04	HP232-04	Tie Rod	1		
05	HP232-05	Reservoir	1		
06	HP232-06	Tail Base	1		
07		O-Ring	1	x	✓
08		Hook Ring	1	x	✓
09		Fixing Hook	1	x	✓
10		Screw	2	x	✓
11		Steel Ball	3	x	✓
12		Set Screw	3	x	✓
13		O-Ring	1	x	✓
14		Back-Up Ring	1	x	✓
15	HP227-17	Pump Piston	1		
16		Snap Ring	1	x	✓
17		O-Ring	1	x	✓
18		Back-Up Ring	1	x	✓
19	HP227-21	Pump Piston	1		
20		Piston Pin	1	x	✓
21		Yoke Pin	1	x	✓
22		Retaining Ring	3	x	✓
23	HP232-23	Yoke	1		
24	HP232-24	Handle	1		
25		Handle Grip	1	x	✓
26	HP232-26	Yoke Base	1		
27		Roll Pin	1	x	✓
28		Oil Seal	1	x	✓
29		Washer	1	x	✓
30	RV	Release Nut	1	x	
31	RV	Pin	1	x	
32	RV	Release Knob	1	x	
33		Steel Ball	2	x	✓

ITEM NO.	PART NO.	DESCRIPTION	QTY.	SPARE PARTS	SERVICE PARTS
34		Steel Ball	2	x	✓
35		Spring	2	x	✓
36		Washer	2	x	✓
37		Valve Cover Screw	2	x	✓
38		Steel Ball	1	x	✓
39		Spring End Cap	1	x	✓
40		O-Ring	2	x	✓
41		Overload Cover Screw	1	x	✓
42		Cap	2	x	✓
43		Short Separator Spring	1	x	✓
44		Air Release Screw	1	x	✓
45		Vent Screw	1	x	✓
46		O-Ring	1	x	✓
47	RV	Knob Screw	1	x	
48	RV	Release Valve Screw	1	x	
49		Spring	1	x	✓
50		Overload Cover Screw	2	x	✓
51		Long Separator Spring	1	x	✓
52		Cone	1	x	✓
53		Cone Seat	1	x	✓
56		Brass Washer	1	x	✓
57		Nut	1	x	✓
58	HP211-52	Release Valve Assy	1		

REVISION

1	
2	5533
3	
4	
5	
6	
7	
8	
9	
10	
11	
12	
13	
14	
15	
16	
17	
18	
19	
20	

NOTE:

- ALL PARTS ARE AVAILABLE TO BE ORDERED AS SPARE PARTS (UNLESS MARKED WITH x).
- PARTS MARKED WITH ✓ ARE AVAILABLE AS SERVICEABLE PARTS, FROM HP232TP1-K ONLY.
- ALL PART NO.S MARKED AS "RV" ONLY AVAILABLE AS RELEASE VALVE ASSEMBLY (ITEM 58)

IMPORTANT

WHEN ORDERING SPARES YOU MUST STATE THE FULL PART NUMBER AND THE PRODUCT SERIAL NUMBER - FROM THE LABEL TO PROTECT YOUR WARRANTY ALWAYS USE GENUINE HI-FORCE PARTS

ITEM NO.	PART NO.	DESCRIPTION	QTY	ITEM NO.	PART NO.	DESCRIPTION	QTY
01	HP232-01	Pump Housing	1	46	X	O-Ring	1
02	X	Oil Filter	1	47	RV	Knob Screw	1
03	X	Ring	2	48	RV	Release Valve Screw	1
04	HP232-04	Tie Rod	1	49	X	Spring	2
05	HP232-05	Reservoir	1	50	X	Overload Cover Screw	1
06	HP232-06	Tail Base	1	51	X	Long Separator Spring	1
07	X	O-Ring	1	52	X	Cone	1
08	X	Hook Ring	1	53	X	Cone Seat	1
09	X	Fixing Hook	1	56	X	Brass Washer	1
10	X	Screw	2	57	X	Nut	1
11	X	Steel Ball	4	58	HP211-52	Release Valve Assy	1
12	X	Set Screw	3				
13	X	O-Ring	1				
14	X	Back-Up Ring	1				
15	HP227-17	Pump Piston	1				
16	X	Snap Ring	1				
17	X	O-Ring	1				
18	X	Back-Up Ring	1				
19	HP227-21	Pump Piston	1				
20	X	Piston Pin	1				
21	X	Yoke Pin	1				
22	X	Retaining Ring	3				
23	HP232-23	Yoke	1				
24	HP232-24	Handle	1				
25	X	Handle Grip	1				
26	HP232-26	Yoke Base	1				
27	X	Roll Pin	1				
28	X	Oil Seal	1				
29	X	Washer	1				
30	RV	Release Nut	1				
31	RV	Pin	1				
32	RV	Release Knob	1				
33	X	Steel Ball	2				
34	X	Steel Ball	2				
35	X	Spring	2				
36	X	Washer	2				
37	X	Valve Cover Screw	2				
38	X	Steel Ball	1				
39	X	Spring End Cap	1				
40	X	O-Ring	2				
41	X	Overload Cover Screw	1				
42	X	Cap	2				
43	X	Short Separator Spring	1				
44	X	Air Release Screw	1				
45	X	Vent Screw	1				

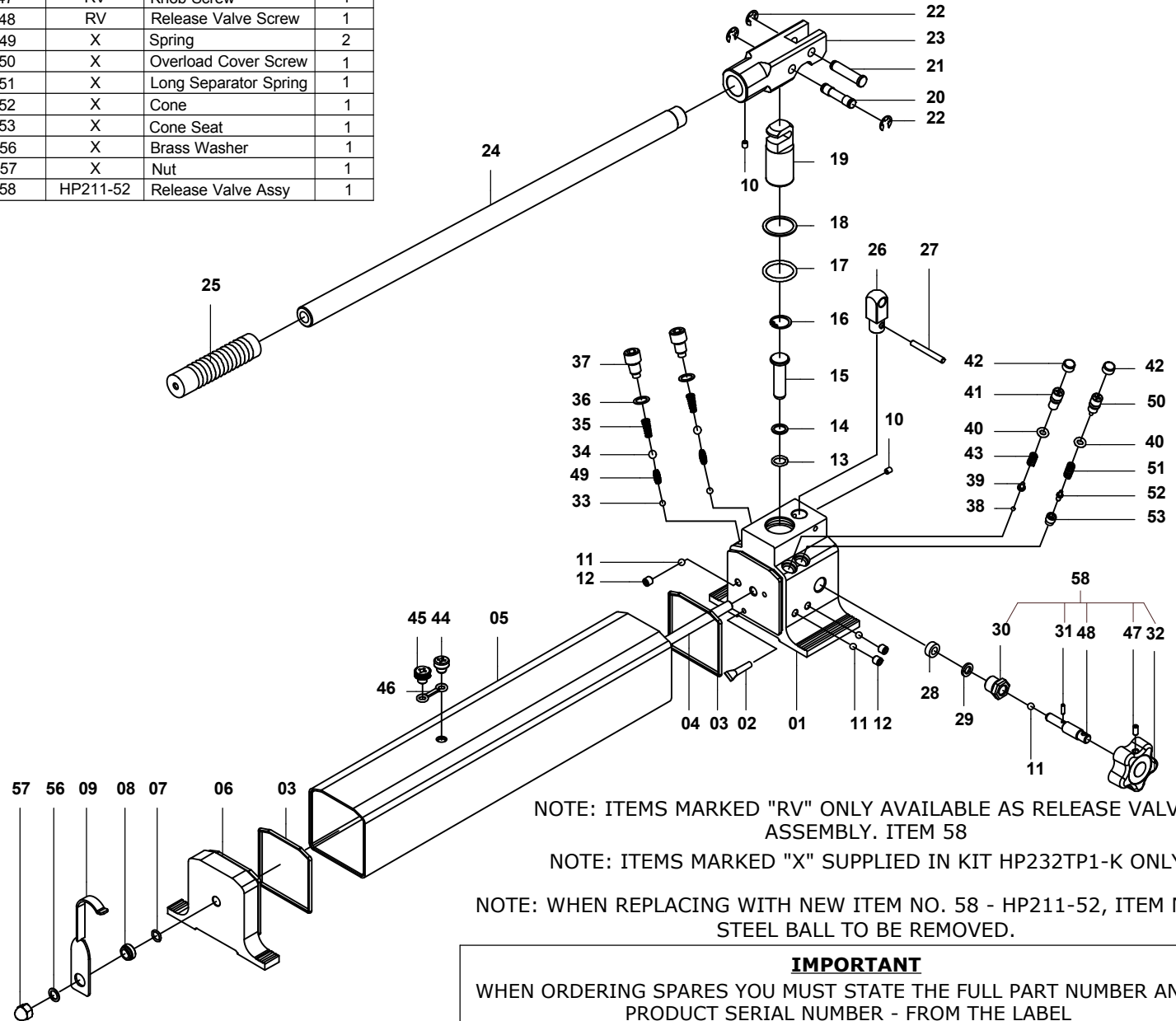

NOTE: ITEMS MARKED "RV" ONLY AVAILABLE AS RELEASE VALVE ASSEMBLY. ITEM 58

NOTE: ITEMS MARKED "X" SUPPLIED IN KIT HP232TP1-K ONLY

NOTE: WHEN REPLACING WITH NEW ITEM NO. 58 - HP211-52, ITEM NO. 11 - STEEL BALL TO BE REMOVED.

IMPORTANT

WHEN ORDERING SPARES YOU MUST STATE THE FULL PART NUMBER AND THE PRODUCT SERIAL NUMBER - FROM THE LABEL TO PROTECT YOUR WARRANTY ALWAYS USE GENUINE HI-FORCE PARTS