

REVISION

1	4131
2	4143
3	
4	
5	
6	
7	
8	
9	
10	
11	
12	
13	
14	
15	
16	
17	
18	
19	
20	

NOTE:  
THE ABOVE DRAWING IS OF A HSP104E104 MODEL  
WHICH IS A 10 WAY SPLIT FLOW PUMP.

MOST ITEMS ARE COMMON BUT QUANTITIES MAY VARY  
BETWEEN MODELS. THE ITEMS THAT ARE NOT COMMON  
ARE MARKED UP WITH AN 'X'. PLEASE REFER TO PAGE 3.

**IMPORTANT**

WHEN ORDERING SPARES YOU MUST STATE THE FULL PART NUMBER AND THE  
PRODUCT SERIAL NUMBER - FROM THE LABEL  
TO PROTECT YOUR WARRANTY ALWAYS USE GENUINE HI-FORCE PARTS.

NOTES:

1. ALL STEEL AND COPPER PIPES ARE MADE TO SUIT. ORDER A LENGTH OF 10mm STEEL OR 15mm COPPER TUBE FROM HI-FORCE AND CUT TO SUIT.

2. FLEXIBLE HOSES: ORDER 700 BAR HOSE ASSEMBLY WITH 1/4BSP SWIVEL FEMALE EACH END AND STATE OVERALL LENGTH REQUIRED.

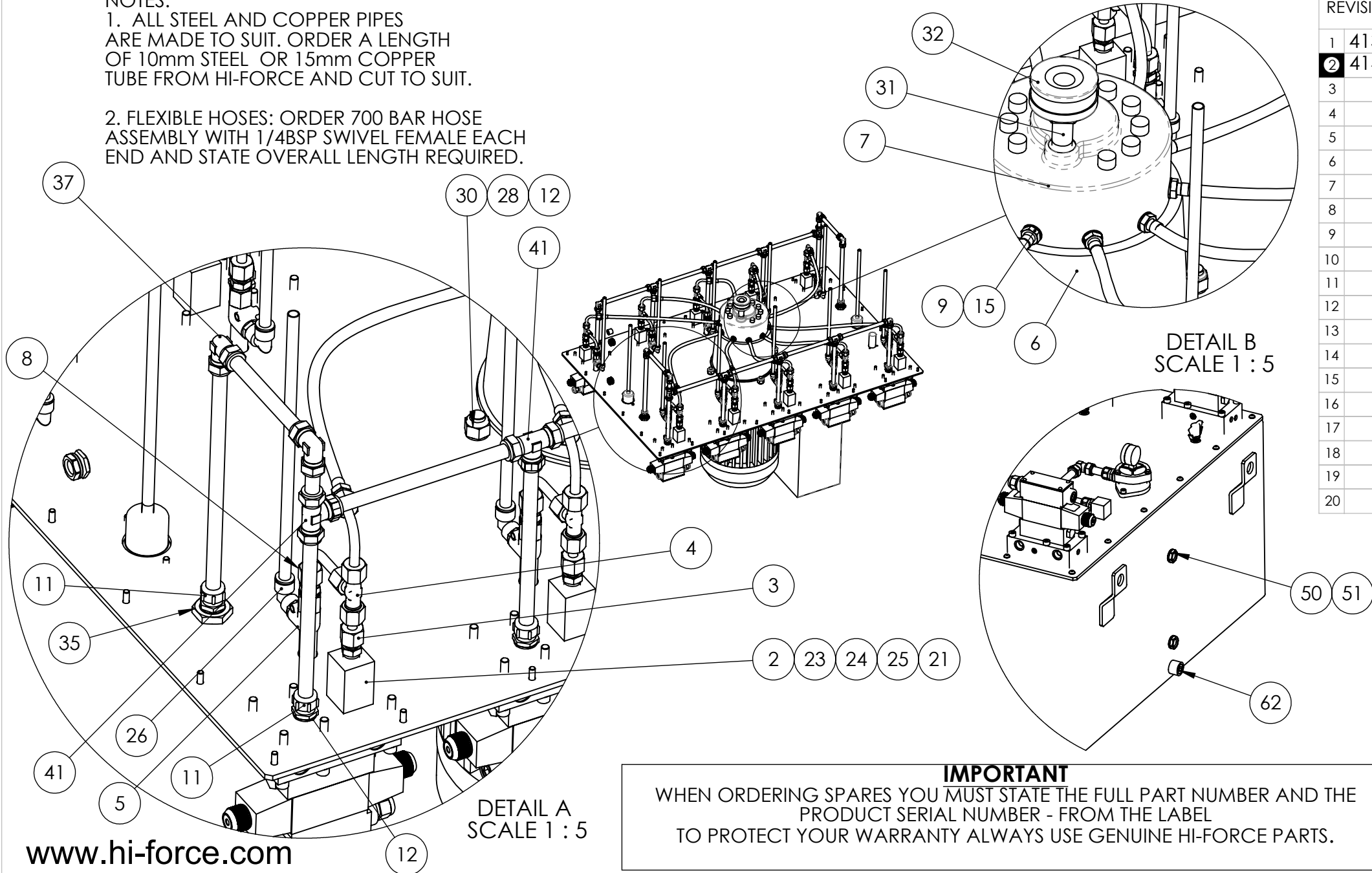

REVISION	
1	4131
2	4143
3	
4	
5	
6	
7	
8	
9	
10	
11	
12	
13	
14	
15	
16	
17	
18	
19	
20	

**IMPORTANT**  
WHEN ORDERING SPARES YOU MUST STATE THE FULL PART NUMBER AND THE PRODUCT SERIAL NUMBER - FROM THE LABEL TO PROTECT YOUR WARRANTY ALWAYS USE GENUINE HI-FORCE PARTS.

ITEM NO.	PART NUMBER	DESCRIPTION
1	X	TANK LID
2	PPC000TA001	CONNECTOR BLOCK
3	FPC010YN001	MALE STUD COUPLER
4	FPC010UT001	TEE
5	VRC700ZE001	ADJ PRESSURE REL VALVE
6	X	BELL HOUSING
7	X	PUMP HEART
8	FPC006YB003	MALE STUD COUPLER
9	WAC007HD000	DOWTY WASHER
11	FPC010LK001	FITTING
12	WAC010HD000	DOWTY WASHER
14	X	MOTOR
15	FPC006QB003	ADAPTOR
21	BLC006JE016	SKT CSK SCREW
22	FFC050TS001	RETURN LINE FILTER
23	15503	CONNECTOR PIPE
24	SEC013RA001	O - RING
25	SEC013BA001	BACK UP RING
26	FPC006DS001	ELBOW
28	BLC016ND040	SOCKET CAP HD SCREW
29	WAC016BB000	M16 SPRING WASHER
30	NUC016PC000	NYLOK NUT
31	FPC013AC001	BARREL NIPPLE
32	FFC045MZ001	FILTER
33	X	TANK
34	FPC026ZB001	CONNECTOR BLOCK

ITEM NO.	PART NUMBER	DESCRIPTION
35	NUC019XB000	THIN NUT
36	FFC028PZ001	FILLER/BREATHER
37	FPC010EK001	COMPRESSION ELBOW
41	FPC010TK001	COMPRESSION TEE
47	WAC006EB000	WASHER
48	BLC006JH020	BUTTON HEAD SCREW
49	BLC006JD020	SOCKET CAP HD SCREW
50	BLC021YT010	SIGHT GLASS
51	NUC021-B000	THIN NUT
52	VFC010BT003	HI- FORCE VALVE BASE.
53	BLC006FC055	SOCKET CAP HD SCREW
54	BLC008KC060	SOCKET CAP HD SCREW
55	EMC000NE001	CONNECTOR BLOCK 6MM
56	FPC006PN001	PLUG
57	NUC020LS002	GLAND 6- 12MM
58	PCC003RB006	M3X 12MM SELLOCK PIN
59	VFA000CE004	4 WAY D/A SOL. VALVE 24V
60	FPC003PN001	PLUG
61	V-8255	LOCK MODULE
62	FPC013PC001	PLUG
63	X	COUPLING
64	SEC057RA001	O-RING
65	FAS006ME007	M6 ORIFICE RESTRICTOR

REVISION

1 4131

2 4143

3

4

5

6

7

8

9

10

11

12

13

14

15

16

17

18

19

20

FOR ITEMS MARKED WITH AN 'X' & QUANTITIES FOR ALL ITEMS PLEASE CONTACT YOUR HI-FORCE OFFICE QUOTING THE PUMP MODEL AND SERIAL No.

**IMPORTANT**

WHEN ORDERING SPARES YOU MUST STATE THE FULL PART NUMBER AND THE PRODUCT SERIAL NUMBER - FROM THE LABEL TO PROTECT YOUR WARRANTY ALWAYS USE GENUINE HI-FORCE PARTS.