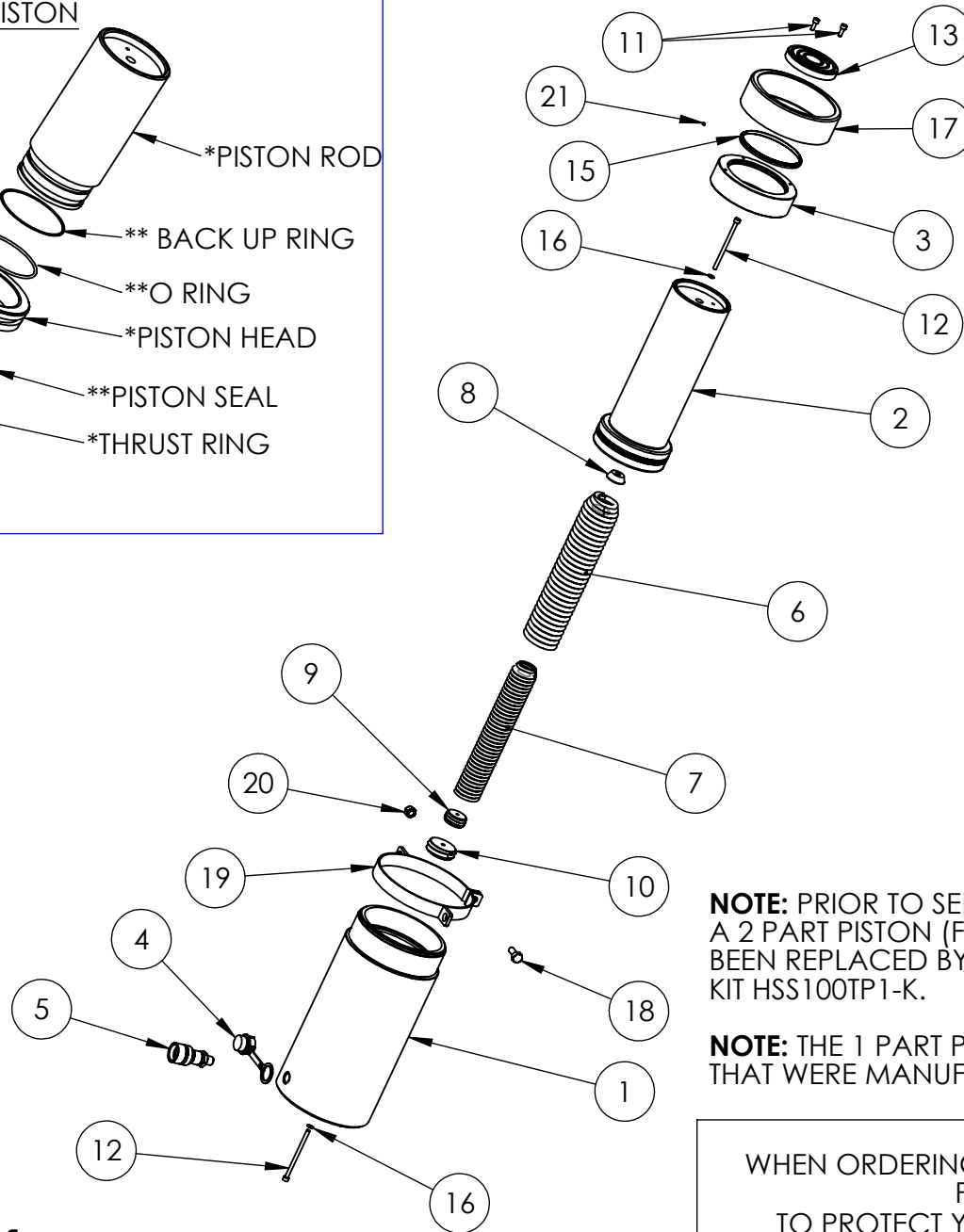
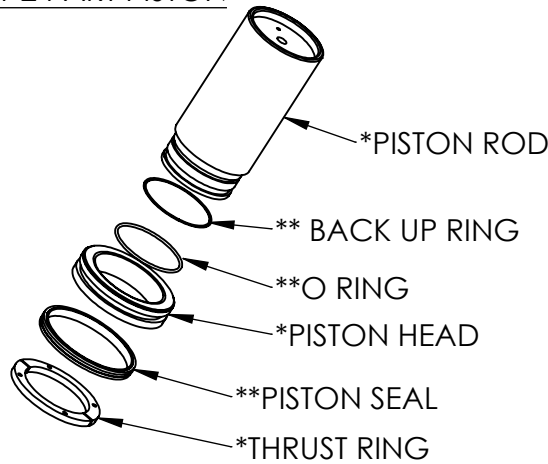

FIG1 2 PART PISTON



FROM SERIAL NO: AX0802 ONWARDS

ITEM NO.	PART NUMBER	DESCRIPTION	QTY.
1	CBC140SG007	CYLINDER	1
2	PRC140BN007	PISTON	1
3	SRC114WN003	STOP RING	1
4	PPC1	DUST COVER	1
5	CF1	COUPLER	1
6	SPC067UP006	SPRING	1
7	SPC040UM001	SPRING	1
8	SIC029EC001	SPRING INSERT	1
9	SIC036TD001	INSERT	1
10	SIC050TD001	INSERT	1
11	BLC006JD016	SOCKET CAP HD SCREW	2
12	BLC006JD100	SOCKET CAP HD SCREW	2
13	HA100	SADDLE	1
14	X	PISTON SEAL	1
15	X	WIPER	1
16	X	WASHER	2
17	PTP175TP100	THREAD PROTECTOR	1
18	BLC010LB030	BOLT	1
19	FLC178LA003	LIFTING RING	1
20	NUC010LC000	NUT	1
21	FFC004RC001	FILTER	1

ALL ITEMS MARKED 'X' SUPPLIED IN SERVICE KIT HSS100TP2-K

NOTE: PRIOR TO SERIAL NO. AX0802 THE CYLINDERS WERE MANUFACTURED WITH A 2 PART PISTON (FIG 1). PARTS MARKED * ARE NOT AVAILABLE, THESE PARTS HAVE BEEN REPLACED BY ITEM NO. 2. PARTS MARKED UP **ARE AVAILABLE IN SERVICE KIT HSS100TP1-K.

NOTE: THE 1 PART PISTON DESIGN IS FULLY INTERCHANGEABLE WITH THE CYLINDERS THAT WERE MANUFACTURED WITH A 2 PART PISTON.

IMPORTANT

WHEN ORDERING SPARES YOU MUST STATE THE FULL PART NUMBER AND THE PRODUCT SERIAL NUMBER - FROM THE LABEL TO PROTECT YOUR WARRANTY ALWAYS USE GENUINE HI-FORCE PARTS.