

Revision

1	5498	2		3	
4		5		6	

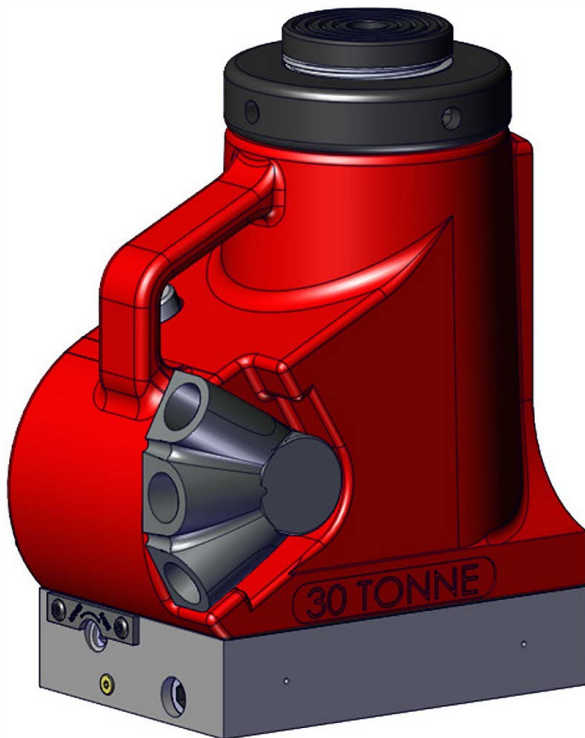

BOM ID	Part number	Description	Qty
1	X	RAM CAP SCREW	1
2	STC086HS001	WIPER RETAINING CLIP	1
3	JHA000DA001	DIP STICK	1
4	X	DIP STICK ORING	1
5	JHC076CC001	630 CISTERN	1
6	JHC000TZ001	TUMBLER ROLLER	1
7	SEC095DE001	GAITER SEAL	2
8	JHC000JZ001	JACK TUMBLER	1
9	STC012AA001	CIRCLIP	2
10	X	TUMBLER SCREW	1
11	JHC000QZ001	QUADRANT SHAFT	1
12	X	QUADRANT ORING	1
13	X	CISTERN ORING	1
14	JHC076MC001	SCRAPER RING	1
15	JHC076AC001	RAM CAP	1
16	JHC076LC003	630 LINER	1
17	STC013BA001	RETAINING CLIP	1
18	FFC012MA001	SUCTION FILTER	1
19	FAS010MA020	CUP PT SCREW	1
20	JHC076BC002	630/1230 LIST BASE	1
21	X	BASE PLUG DOWTY WASHER	1
22	X	BASE PLUG SCREW	1
23	X	BASE SCREWS	6
24	VRA700AF002	RELIEF VALVE	1
25	X	BASE ORING	1
26	FPC008PM001	PLUG	1
27	SPC009PA001	SUCTION SPRING	1
28	X	DOWTY WASHER	2
29	X	SUCTION SCREW	1
30	SPC012CA001	RELEASE VALVE SPRING	1
31	SEC013RA001	RELEASE VALVE ORING	1
32	JAC010JC002	RELEASE VALVE SPINDLE	1
33	JHC000KZ001	PUMP BARREL	1
34	X	PUMP BARREL WASHER	1
35	FAS016OC019	RELEASE VALVE SCREW	1
36	X	DELIVERY SCREW	1
37	SPC009PA001	DELIVERY SPRING	1
38	X	8mm BALL	3
39	X	PUMP PLUNGER ORING	1
40	X	PUMP PLUNGER BACKUP	1
41	JHC000UZ001	PUMP PLUNGER	1
42	JHC000UZ002	PUMP PLUNGER CIRCLIP	1
43	JHC076YC001	630 CISTERN	1
44	PCC003FC002	Dowel pin hardened & ground	1
45	X	6mm BALL	1
46	SPC006CA007	RELIEF VALVE SPRING	1
47	JHC000VZ001	SAFE STOP VALVE BODY	1
48	JHC000GZ001	RELEASE PLATE	1
49	X	BUTTON HEAD PLATE SCREW	2
50	X	RAM SEAL 30 TONNE	1
51	X	30 TONNE BACKUP	1
52	X	PISTON PLUG SCREW	1
53	X	PISTON PLUG DOWTY WASHER	1
54	X	SPRING PIN	2
55	JHC000WC001	SAFE STOP BAR	1
56	JHC000WC002	SAFE STOP RING	2
57	SPC003CA001	COMPRESSION SPRING	2
58	JHC076RC003	630 SR RAM	1
59	JHC076SC001	STOP RING	1

ITEMS MARKED X ARE AVAILABLE
IN SERVICE KIT JAH30TP2-K ONLY

IMPORTANT
WHEN ORDERING SPARES YOU MUST STATE THE FULL PART NUMBER AND THE
PRODUCT SERIAL NUMBER - FROM THE LABEL
TO PROTECT YOUR WARRANTY ALWAYS USE GENUINE HI-FORCE PARTS.

Revision	1	5498	2		3	
	4		5		6	