

Revision

1	5498	2		3	
4		5		6	

21 22

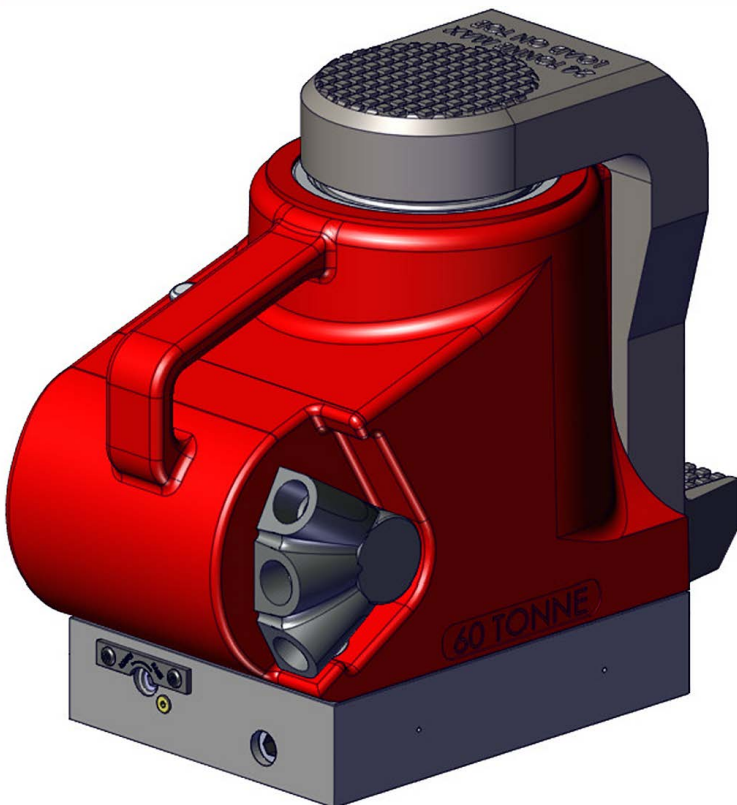

BOM ID	Part number	Description	Qty
1	JHC108AD002	60T CLAW RAM CAP	1
2	X	WIPER	1
3	JHC108CD001	660 CISTERN	1
4	X	QUADRANT O RING	1
5	JHC000QZ001	QUADRANT SHAFT	1
6	X	TUMBLER SCREW	1
7	STC012AA001	CIRCLIP	2
8	SEC136DE001	GAITER SEAL	2
9	JHC000JZ001	JACK TUMBLER	1
10	JHC000TZ001	TUMBLER ROLLER	1
11	X	DIP STICK ORING	1
12	X	CISTERN O-RING	1
13	X	WIPER RETAINING RING	1
14	X	RAM CAP SCREW	1
15	X	BASE O-RING	1
16	STC013BA001	FILTER RETAINING CLIP	1
17	FFC012MA001	SUCTION FILTER	1
18	JHC108BD002	660/1260 LIST BASE	1
19	X	BASE PLUG DOWTY WASHER	1
20	X	BASE PLUG SCREW	1
21	X	BASE SCREWS	6
22	X	SHORT BASE SCREW	1
23	SPC012CA001	RELEASE VALVE SPRING	1
24	FPC008PM001	PLUG	1
25	SPC009PA001	SUCTION SPRING	1
26	X	DELIVERY SCREW	2
27	JHC000GZ001	RELEASE PLATE	1
28	X	BUTTON HEAD PLATE SCREW	2
29	JAC010JC002	RELEASE VALVE SPINDLE	1
30	FAS016OC019	RELEASE VALVE SCREW	1
31	SPC009PA001	DELIVERY SPRING	1
32	X	DOWTY WASHER	2
33	SEC013RA001	RELEASE VALVE O RING	1
34	X	PUMP BARREL WASHER	1
35	X	8mm BALL	2
36	JHC000KZ001	PUMP BARREL	1
37	X	PUMP PLUNGER O-RING	1
38	X	PUMP PLUNGER BACK UP	1
39	JHC000UZ001	PUMP PLUNGER	1
40	JHC000UZ002	PUMP PLUNGER CIRCLIP	1
41	JHC108YD001	60T BASE GASKET	1
42	JHC108LD003	660 LINER	1
43	JHC000WD002	SAFE STOP RING	2
44	X	SPRING PIN	2
45	X	BASE PLUG SCREW	1
46	X	6mm BALL	1
47	JHC000VZ001	SAFE STOP VALVE BODY	1
48	X	60 TONNE BACKUP	1
49	X	RAM SEAL	1
50	JHC000WD001	SAFE STOP BAR	1
51	SPC006CA007	RELIEF VALVE SPRING	1
52	PCC003FC002	Dowel pin hardened & ground	1
53	X	PISTON PLUG DOWTY WASHER	1
54	SPC003CA001	COMPRESSION SPRING	2
55	JHC108PD003	660 PLAIN RAM	1
56	VRA700AF002	RELIEF VALVE	1
57	JHA000DA001	DIP STICK	1
58	JHC108DD001	60 TONNE CLAW	1
59	JHC108DD003	60T CLAW PAD	1
60	BLC005HF016	SKT CSK SCREW	2

ITEMS MARKED X ARE AVAILABLE
IN SERVICE KIT JAH60TP2-K ONLY

IMPORTANT
WHEN ORDERING SPARES YOU MUST STATE THE FULL PART NUMBER AND THE
PRODUCT SERIAL NUMBER - FROM THE LABEL
TO PROTECT YOUR WARRANTY ALWAYS USE GENUINE HI-FORCE PARTS.

Revision

1	5498	2		3	
4		5		6	