

SELF CONTAINED CABLE CRIMPING TOOL. SC30

SERIAL NUMBERS

ALL

SPARE PARTS LIST NO.

SC30 Iss 4

ITEM NO.	PART NO.	DESCRIPTION	QTY.	ITEM NO.	PART NO.	DESCRIPTION	QTY.	ITEM NO.	PART NO.	DESCRIPTION	QTY.
1	SC30-01	Crimping Head	1	28	SC30-28	Release Pin	1	54	X	Back-Up Ring	2
2	SC30-02	Ram	1	29	X	Spring	1	55	X	Back-Up Ring	1
3	SC30-03	Screw	1	30	SC30-30	Suction Valve	1	56	X	Back-Up Ring	1
4	SC30-04	Release Spring	1	31	X	Valve Base	1	57	X	Washer	1
5	SC30-05	Washer	1	32	X	Spring	1	58	X	Dowel Pin Pin	1
6	DL	Knob	1	33	SC30-33	Needle	1	59	X	Pin	1
7	DL	Nut	1	34	SC30-34	Cylinder	1	60	X	Pin	1
8	DL	Spring	1	35	SC30-35	Lever Head	1	61	X	O-Ring	1
9	DL	Valve Screw	1	36	X	Bushing	4	62	X	O-Ring	1
10	SC30-10	Pin	1	37	X	Pivot Pin	1	63	X	O-Ring	1
11	X	Washer	1	38	X	Plunger Pin	1	64	X	O-Ring	1
12	X	Retainer Pin	1	39	X	Spring	1	65	X	O-Ring	1
13	X	Ram Spring	1	40	X	Pin	1	66	X	O-Ring	2
14	X	Pin	1	41	X	Stud	1	67	X	O-Ring	1
15	X	Die Release Lever	1	42	SC30-42	Rubber Cover	1	68	X	O-Ring	1
16	X	Screw	2	43	SC30-43	Lever	1	69	X	O-Ring	2
17	X	Spring	2	44	SC30-44	Handle Grip	1	70	X	O-Ring	1
19	X	Spring	1	45	SC30-45	Rubber Cover	1	71	X	Screw	2
20	X	Screw	1	46	X	Retainer Clip	1	72	X	Screw	1
21	X	Spring	1	47	SC30-47	Reservoir	1	73	X	Screw	2
22	SC30-22	Screw	1	48	SC30-48	Reservoir Plug	1	74	X	Screw	1
23	X	Spring	2	49	SC30-49	Boot	1	75	X	Steel Ball	1
24	X	Steel Ball Cap	1	50	SC30-50	Locking Handle	1	76	X	Steel Ball	2
25	X	Adjust Screw	1	51	SC30-51	Rubber Cover	1	77	X	Steel Ball	2
26	SC30-26	Piston	1	52	SC30-52	Rubber Grip	1	78	X	Steel Ball	2
27	SC30-27	Screw	1	53	X	Filter	1	79	X	Snap Ring	1
								80	X	Snap Ring	1
								81	X	Snap Ring	2
								82	SC30-06	Die Locking Pin	1
								83	X	Dust Ring	1

REVISION	
1	
2	4939
3	5074
4	5203
5	
6	
7	
8	
9	
10	
11	
12	
13	
14	
15	
16	
17	
18	
19	
20	

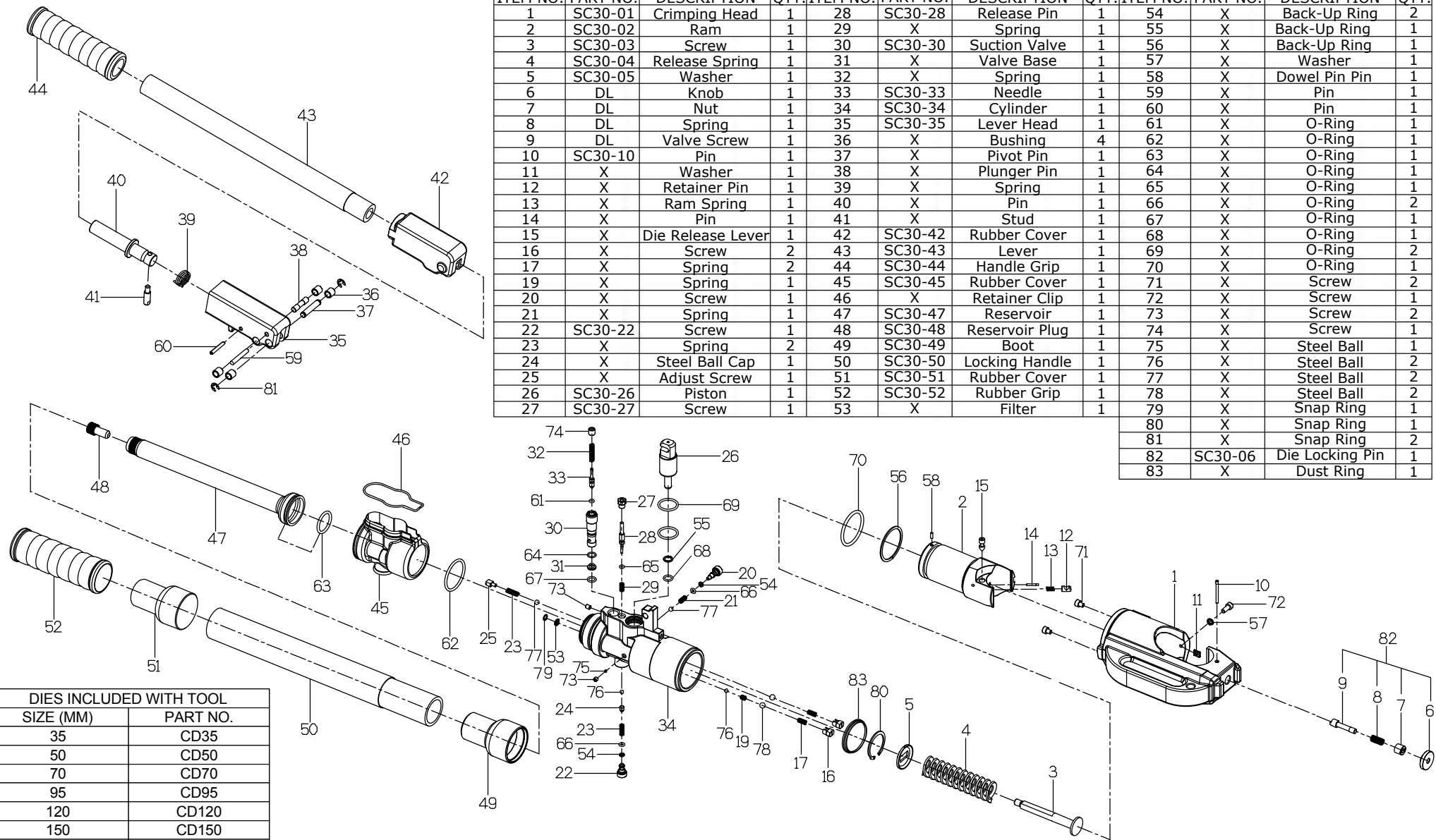

DIES INCLUDED WITH TOOL	
SIZE (MM)	PART NO.
35	CD35
50	CD50
70	CD70
95	CD95
120	CD120
150	CD150
185	CD185
240	CD240
300	CD300
400	CD400

NOTE: ITEMS MARKED "X" SUPPLIED IN KIT SC30TP1-K ONLY

IMPORTANT
WHEN ORDERING SPARES YOU MUST STATE THE FULL PART NUMBER AND THE PRODUCT SERIAL NUMBER FROM THE LABEL.
TO PROTECT YOUR WARRANTY ALWAYS USE GENUINE HI-FORCE PARTS