

DRAWING CHANGE

1
134907
14**2**
155356
163
174
185
196
207
218
229
2310
2411
2512
2613
2714
2815
2916
3017
3118
3219
3320
3421
3522
3623
3724
3825
3926
4027
4128
4229
4330
44

INC REV. DRAWINGS AT REVISION #.# ARE VALID FOR USE WITH DOCUMENTATION FOR REVISION #

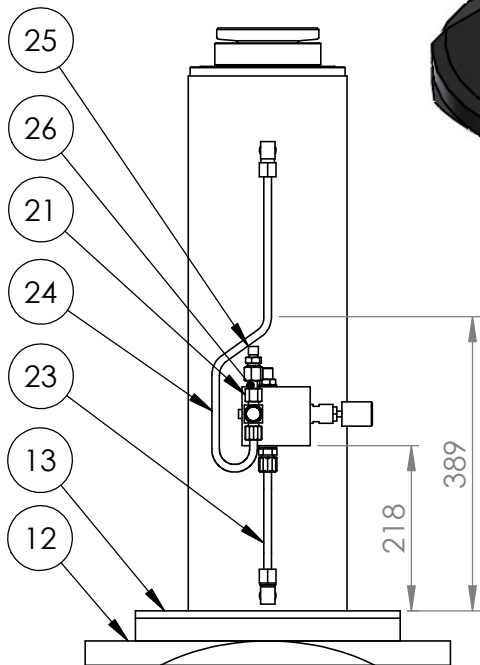
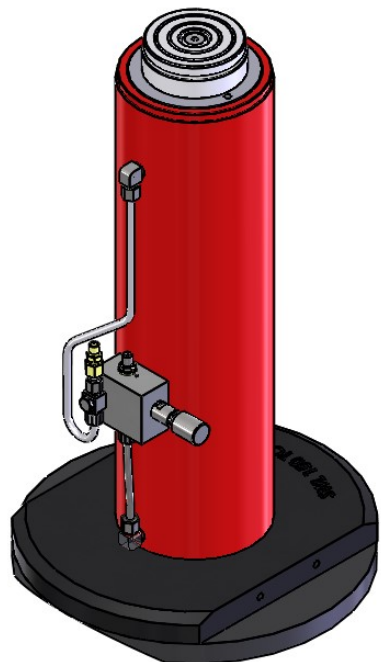

NOTE:
MAKE PIPES OFF TO FIT THE DIMENSIONS SHOWN TO LEFT.

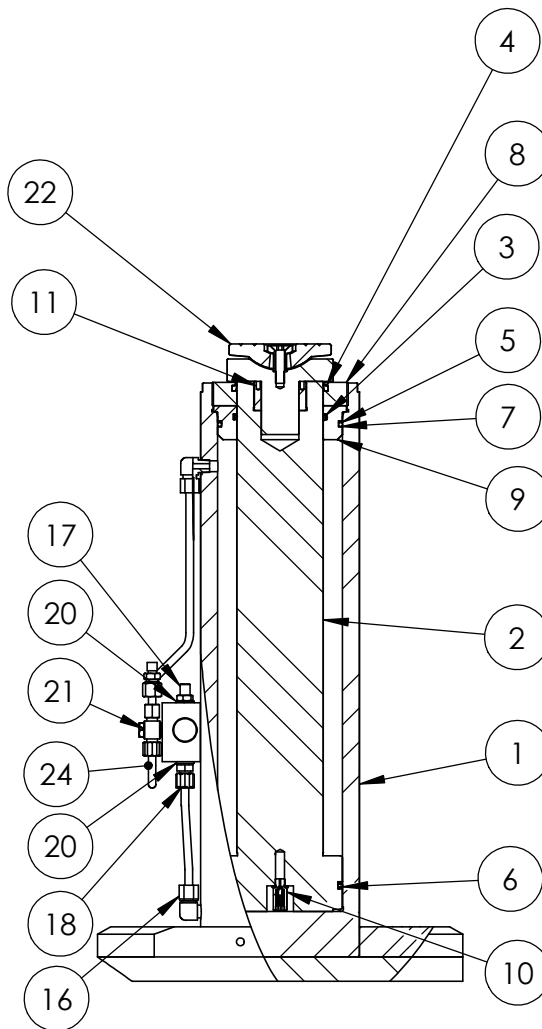

ITEM NO.	PART NUMBER	DESCRIPTION	QTY.
1	CBC165AR002	CYLINDER	1
2	PRC165VR002	PISTON.	1
3	X	ROD SEAL	1
4	X	WIPER	1
5	X	BACK UP RING	1
6	X	PISTON TEE SEAL	1
7	X	O-RING	1
8	SRC114WQ002	STOP RING	1
9	SSC165EA001	SEAL RETAINER.	1
10	VRA700AF002	RELIEF VALVE	1
11	ADC150PA001	ADAPTOR	1
12	ADC200BC009	BASE PLATE	1
13	ADC150BC001	INTERMEDIATE PLATE	1
14	BLC016ND040	M6xT6 SOCKET CAP HD SCREW	8
15	BLC020PC040	M6xT6 SOCKET CAP HD SCREW	4
16	FPC010DN001	MALE STUD ELBOW	2
17	FPC010NB001	REDUCER	1
18	FPC010YB001	STUD COUPLING	1
19	VFA006NV001	LOWERING VALVE	1
20	WAC016KD001	DOWTY WASHER	2
21	FPC010QB004	10mm BANJO	1
22	TLS150	TILTING SADDLE	1
23	HOC010PS006	FULL BORE PIPE	1
24	HOC010PS005	PRE-BENT TUBE ASSEMBLY	1
25	FPC006YB003	MALE STUD COUPLER	1
26	TL PIPE 15020TP2	10mm OD STUB PIPE	1

NOTE:
PARTS MARKED 'X' ARE PART OF REPAIR KIT HDA150TP1-K

Hi-Force
HYDRAULIC TOOLSTITLE:
TOUGHLIFT CYLINDER ASSEMBLYPROSPECT WAY, DAVENTRY
NORTHANTS. NN11 8PLTHIS DRAWING IS THE SOLE PROPERTY OF HI-FORCE LTD.
AND MUST NOT BE LOANED, COPIED OR
USED IN ANY WAY WITHOUT THE WRITTEN CONSENT OF THE Co.DRAWN
MM
DATE
15/06/2016
CHKD
MJDMATERIAL:

FINISH:

REMARKS

UNLESS SPECIFIED
OTHERWISE, M/C FINISH
Ra 1.6 µm

DO NOT SCALE

ALL DIMS ARE IN mm AND INCLUDE ANY
SURFACE TREATMENTS.
TOLERANCES (UNLESS SPECIFIED OTHERWISE):
LINEAR DIMS ±0.25
ANGULAR DIMS ±0.5°
COAXIAL DIAMS TO BE CONCENTRIC TO WITHIN
0.05 T.I.R. REMOVE ALL BURRS AND SHARP EDGES

COMPONENT DRG NO.

HDA15020TL

SHT 1 OF 1 SHTS