

| | | | | | | | | | | | | | | | |
|----------------|----|------|----|------|----|----|----|----|----|----|----|----|----|----|---|
| DRAWING CHANGE | 1 | 4907 | 2 | 5356 | 3 | 4 | 5 | 6 | 7 | 8 | 9 | 10 | 11 | 12 | INC REV. DRAWINGS AT REVISION #.# ARE VALID FOR USE WITH DOCUMENTATION FOR REVISION # |
| | 13 | | 14 | | 15 | 16 | 17 | 18 | 19 | 20 | 21 | 22 | 23 | 24 | |

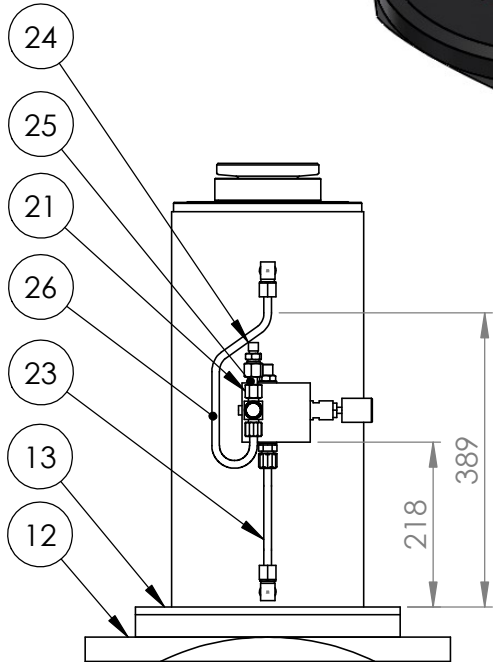

NOTE:
MAKE PIPES OFF TO
FIT THE DIMENSIONS
SHOWN TO LEFT.

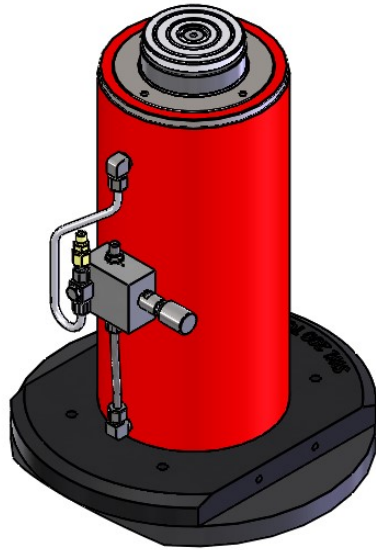
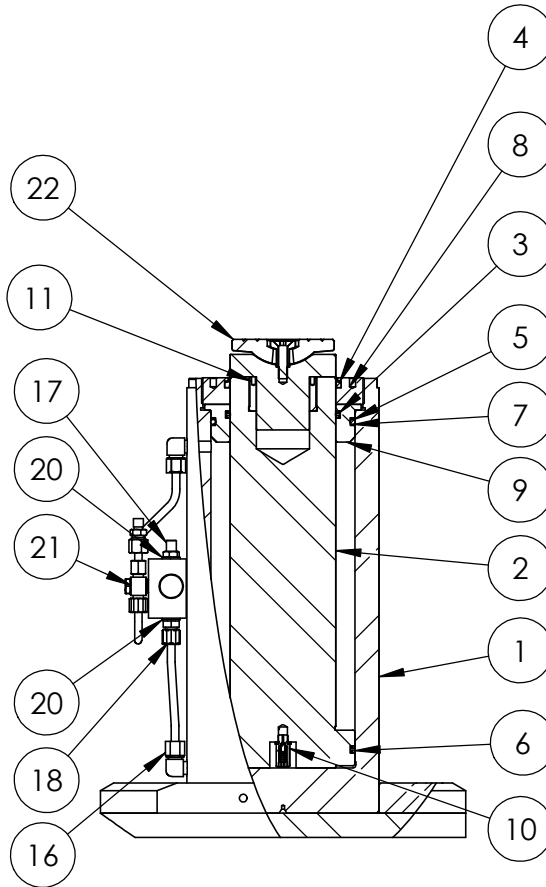

| ITEM NO. | PART NUMBER | DESCRIPTION | QTY. |
|----------|------------------|---------------------------|------|
| 1 | CBC190AP001 | CYLINDER | 1 |
| 2 | PRC190DP001 | PISTON | 1 |
| 3 | X | ROD SEAL | 1 |
| 4 | X | WIPER | 1 |
| 5 | X | BACK UP RING | 1 |
| 6 | X | PISTON SEAL | 1 |
| 7 | X | O-RING | 1 |
| 8 | SRC140WQ002 | STOP RING | 1 |
| 9 | SSC190EA001 | SEAL RETAINER | 1 |
| 10 | VRA700AF002 | RELIEF VALVE | 1 |
| 11 | ADC200PA001 | ADAPTOR | 1 |
| 12 | ADC200BC009 | BASE PLATE | 1 |
| 13 | ADC200BC002 | INTERMEDIATE PLATE | 1 |
| 14 | BLC016ND040 | M6x16 SOCKET CAP HD SCREW | 8 |
| 15 | BLC020PC040 | M6x16 SOCKET CAP HD SCREW | 4 |
| 16 | FPC010DN001 | MALE STUD ELBOW | 2 |
| 17 | FPC010NB001 | REDUCER | 1 |
| 18 | FPC010YB001 | STUD COUPLING | 1 |
| 19 | VFA006NV001 | LOWERING VALVE | 1 |
| 20 | WAC016KD001 | DOWTY WASHER | 2 |
| 21 | FPC010QB004 | 10mm BANJO | 1 |
| 22 | TLS200 | TILTING SADDLE ASSEMBLY | 1 |
| 23 | HOC010PS006 | FULL BORE PIPE | 1 |
| 24 | FPC006YB003 | MALE STUD COUPLER | 1 |
| 25 | TL PIPE 20015TP2 | 10mm OD STUB PIPE | 1 |
| 26 | HOC010PS005 | PRE-BENT TUBE ASSEMBLY | 1 |

NOTE:
PARTS MARKED 'X' ARE PART OF
REPAIR KIT HDA200TP1-K

| | | | | | | |
|---|---|------------|-----------|---|--|-------------------|
| <p>PROSPECT WAY, DAVENTRY NORTHANTS. NN11 8PL</p> | TITLE: | DRAWN | MATERIAL: | REMARKS | <p>DO NOT SCALE</p> <p>ALL DIMS ARE IN mm AND INCLUDE ANY SURFACE TREATMENTS. TOLERANCES (UNLESS SPECIFIED OTHERWISE): LINEAR DIMS ±0.25 ANGULAR DIMS ±0.5° COAXIAL DIAMS TO BE CONCENTRIC TO WITHIN 0.05 T.I.R. REMOVE ALL BURRS AND SHARP EDGES</p> | COMPONENT DRG NO. |
| | TOUHLIFT CYLINDER ASSEMBLY | MM | | | | |
| | DATE | 15/06/2016 | FINISH: | UNLESS SPECIFIED OTHERWISE, M/C FINISH Ra 1.6 µm | | |
| | THIS DRAWING IS THE SOLE PROPERTY OF HI-FORCE LTD. AND MUST NOT BE LOANED, COPIED OR USED IN ANY WAY WITHOUT THE WRITTEN CONSENT OF THE Co. | CHKD | MJD | | | HDA20015TL |
| | | | | | | SHT 1 OF 1 SHTS |