

REVISION NO	
1	
2	
3	
4	
5	
6	
7	
8	
9	
10	
11	
12	
13	
14	
15	
16	
17	
18	
19	
20	

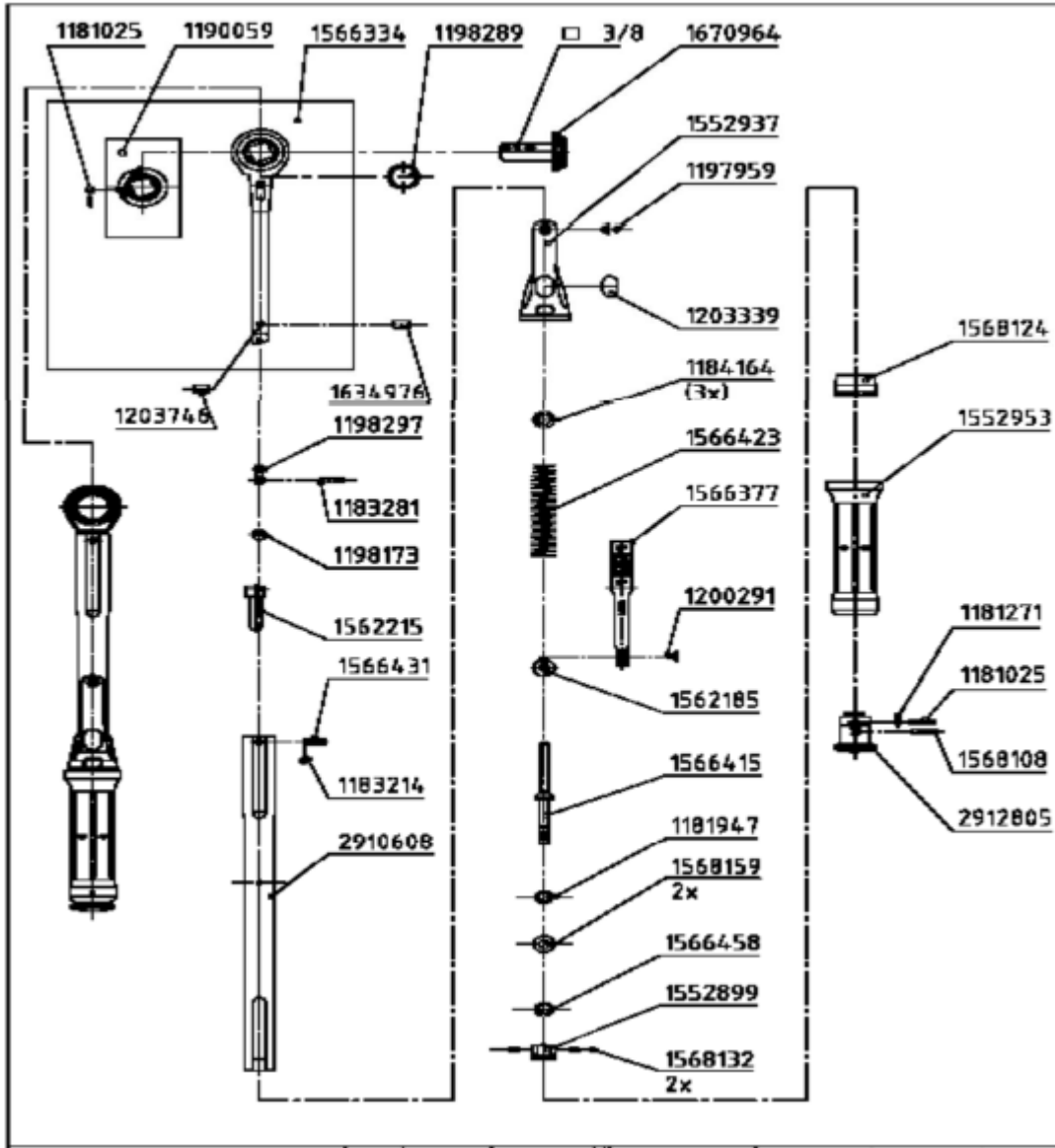

**HI-FORCE MANUAL TORQUE WRENCH
SPARE PARTS BREAKDOWN SHEET FOR TWM50**

IMPORTANT

WHEN ORDERING SPARES YOU MUST STATE THE FULL PART NUMBER AND THE PRODUCT SERIAL NUMBER – FROM THE LABEL.
TO PROTECT YOUR WARRANTY ALWAYS USE GENUINE HI-FORCE PARTS.

SPARE PARTS LIST
TWM 50 – 5 – 50Nm

Part No:	Description	Quantity
1181025	Compression Spring 0.4 x2.8 x 7	2
1190059	Pseudo Kit	1
1203746	Set Screw ISO4029 45H M4 x 3	1
1566334	4549-05 Primary Lever	1
1634976	Set Screw ISO4026 M4 x 8	1
1198297	4150 Connecting link	1
1183281	Cylindrical Pin 2.2 x 10	1
1198173	4150 Roller	1
1562215	4549 Shank	1
1566431	4549-05 bold	1
1183214	Retaining Washer DIN 6799 2.3	1
2910608	TWM50 Body	1
1670964	Mushroom Head Square 3/8"	1
1552937	4549 Scale Frame RAL9005	1
1197959	Countersunk Screw DIN965 M3 x 4.5 black	1
1203339	51715101 Plastic Window	1
1184164	Shim Ring DIN988 8 x 14 x 1	3
1566423	4549-05 Compression Spring	1
1566377	4549-05 Scale Sheet 5-50Nm	1
1200291	4550 Scale screw M3 x 3.8	1
1562185	4549-02 Thread Insert M6 x 1	1
1566415	4549-05 Headless Screw	1
1181947	Shim Ring DIN988 6 x 12 x 0.3	1
1568159	Washer DIN1440-7	2
1566458	Safety Ring DIN472 15 x 1	1
1552899	4549 toothed plug	1
1568132	Cylindrical Pin ISO 8734 3m6 x 4	2
1568124	4549 Scale Ring RAL3020 0.25	1
1552953	4549 Plastic Handle RAL9005	1
1181271	Roller DIN 5401-3 G500	1
1568108	Cylindrical Pin ISO 8734 3m6 x 28	1
2912805	4549 Adjusting Knob	1

IMPORTANT

WHEN ORDERING SPARES YOU MUST STATE THE FULL PART NUMBER AND THE PRODUCT SERIAL NUMBER – FROM THE LABEL.
TO PROTECT YOUR WARRANTY ALWAYS USE GENUINE HI-FORCE PARTS.